

R 25 Ø25 graphite brush 20W 石墨电刷 20W

				Order number 订货号			
				100251	100252	100253	100254
Motor parameters							
1	Nominal voltage 额定电压	U_N	V	12	24	36	48
2	Terminal resistance 电阻	R	Ω	0.517	1.53	4.37	8.49
3	Output power 输出功率	P_{2max}	W	26	33	29	28
4	Efficiency 最大效率	η_{max}	%	86	86	89	89
5	No-load speed 空载转速	n_0	rpm	9620	10900	10100	9540
6	No-load current 空载电流	I_0	A	0.12	0.085	0.025	0.017
7	Stall torque 堵转转矩	M_H	mNm	268	325	279	270
8	Friction torque 摩擦转矩	M_F	mNm	0.5	0.5	0.5	0.5
9	Speed constant 速度常数	k_n	rpm/V	806	457	281	199
10	Back-EMF constant 反电动势常数	k_E	mV/rpm	1.24	2.19	3.55	5.02
11	Torque constant 转矩常数	k_M	mNm/A	11.85	20.91	33.93	47.90
12	Current constant 电流常数	k_I	A/mNm	0.084	0.048	0.029	0.021
13	Slope of n-M curve 转速-转矩曲线斜率	$\Delta n/\Delta M$	rpm/mNm	35.16	33.41	36.24	35.33
14	Mechanical time constant 机械时间常数	τ_m	ms	5.63	5.24	5.16	5.13
15	Rotor inertia 转子惯量	J	gcm ²	14.5	14.7	13.5	13.8
16	Angular acceleration 最大角加速度	α_{max}	10 ³ rad/s ²	184	221	206	195
17	Thermal resistance 热阻	R_{th1} / R_{th2}	K/W	5.1 / 14.4			
18	Thermal time constant 热时间常数	τ_{w1} / τ_{w2}	s	27.7 / 543			
19	Operating temperature range 工作温度范围		°C	-30 ... +85			
20	Shaft bearings 轴承			Sleeve bearing			
21	Shaft load max 轴载荷						
	- radial at 3,000rpm (3mm from bearing)		N	20			
	- axial at 3,000rpm (axial push-on only)		N	2			
	- axial at standstill (axial push-on only)		N	20			
22	Shaft play 轴间隙						
	- radial 径向	\leq	mm	0.025			
	- axial 轴向	\leq	mm	0.15			
23	Magnet material 永磁材料			Sintered Nd-Fe-B			
24	Housing material 外壳材料			Steel, black coated			
25	Pole pairs 极对数		p	1			
26	Weight 重量		g	115			
27	Direction of rotation 旋转方向			Clockwise, viewed from the front face			
Operating Data for η_{max} of Customer's Specifications							
28	Output power 输出功率	P_{2opt}	W	24	31	28	28
29	Efficiency 效率	η_{opt}	%	80	82	85	85
30	Speed 转速	n_{opt}	rpm	8310	9690	8860	8360
31	Load current 电流	I_{opt}	A	2.48	1.56	0.93	0.68
32	Operating torque 转矩	M_{opt}	mNm	27.5	30.4	30.7	31.7

Recommended areas for continuous operation

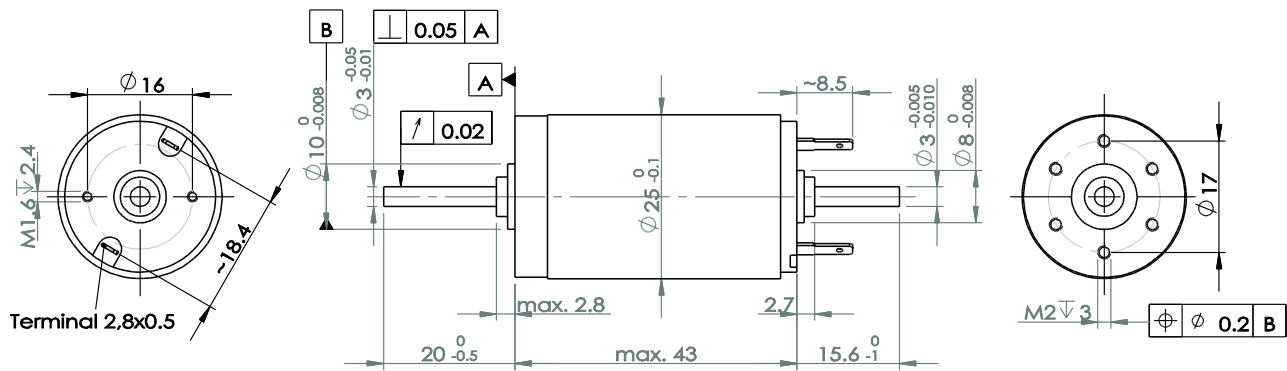
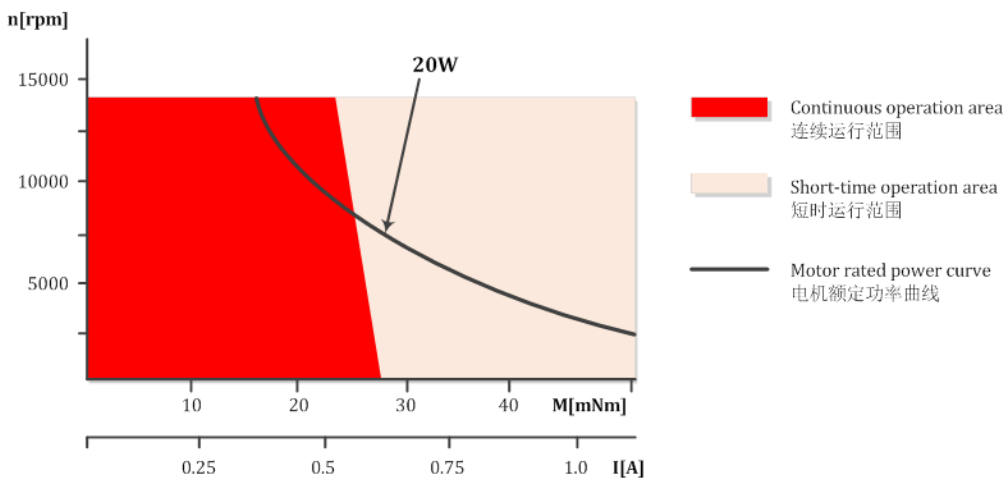

Dimension 尺寸图