

R 50 Ø50 graphite brush 200W 石墨电刷 200W

				Order number 订货号			
				100282	100283	100284	
Motor parameters							
1	Nominal voltage 额定电压	U_N	V	24	36	48	
2	Terminal resistance 电阻	R	Ω	0.103	0.244	0.608	
3	Output power 输出功率	P_{2max}	W	246	242	207	
4	Efficiency 最大效率	η_{max}	%	94	94	93	
5	No-load speed 空载转速	n_0	rpm	5950	5680	4900	
6	No-load current 空载电流	I_0	A	0.236	0.147	0.089	
7	Stall torque 堵转转矩	M_H	mNm	8920	8920	7370	
8	Friction torque 摩擦转矩	M_F	mNm	4.5	4.5	4.5	
9	Speed constant 速度常数	k_n	rpm/V	248	158	102	
10	Back-EMF constant 反电动势常数	k_E	mV/rpm	4.03	6.33	9.78	
11	Torque constant 转矩常数	k_M	mNm/A	38.48	60.46	93.44	
12	Current constant 电流常数	k_I	A/mNm	0.026	0.017	0.011	
13	Slope of n-M curve 转速-转矩曲线斜率	$\Delta n/\Delta M$	rpm/mNm	0.66	0.64	0.66	
14	Mechanical time constant 机械时间常数	τ_m	ms	3.75	3.74	3.78	
15	Rotor inertia 转子惯量	J	gcm ²	536	560	542	
16	Angular acceleration 最大角加速度	α_{max}	10 ³ rad/s ²	166	159	136	
17	Thermal resistance 热阻	R_{th1} / R_{th2}	K/W	1.2 / 3.8			
18	Thermal time constant 热时间常数	τ_{w1} / τ_{w2}	s	71.7 / 1370			
19	Operating temperature range 工作温度范围		°C	-30 ... +85			
20	Shaft bearings 轴承			Preloaded ball bearing			
21	Shaft load max 轴载荷						
	- radial at 3,000rpm (15mm from bearing)		N	100			
	- axial at 3,000rpm (axial push-on only)		N	25			
	- axial at standstill (axial push-on only)		N	120			
22	Shaft play 轴间隙						
	- radial 径向	\leq	mm	0.025			
	- axial 轴向	\leq	mm	0			
23	Magnet material 永磁材料			Sintered Nd-Fe-B			
24	Housing material 外壳材料			Steel, black coated			
25	Pole pairs 极对数		p	1			
26	Weight 重量		g	1100			
27	Direction of rotation 旋转方向			Clockwise, viewed from the front face			
Operating Data for η_{max} of Customer's Specifications							
28	Output power 输出功率	P_{2opt}	W	241	237	203	
29	Efficiency 效率	η_{opt}	%	92	92	91	
30	Speed 转速	n_{opt}	rpm	5680	5420	4620	
31	Load current 电流	I_{opt}	A	10.88	7.13	4.63	
32	Operating torque 转矩	M_{opt}	mNm	405.0	418.0	420.0	

Recommended areas for continuous operation

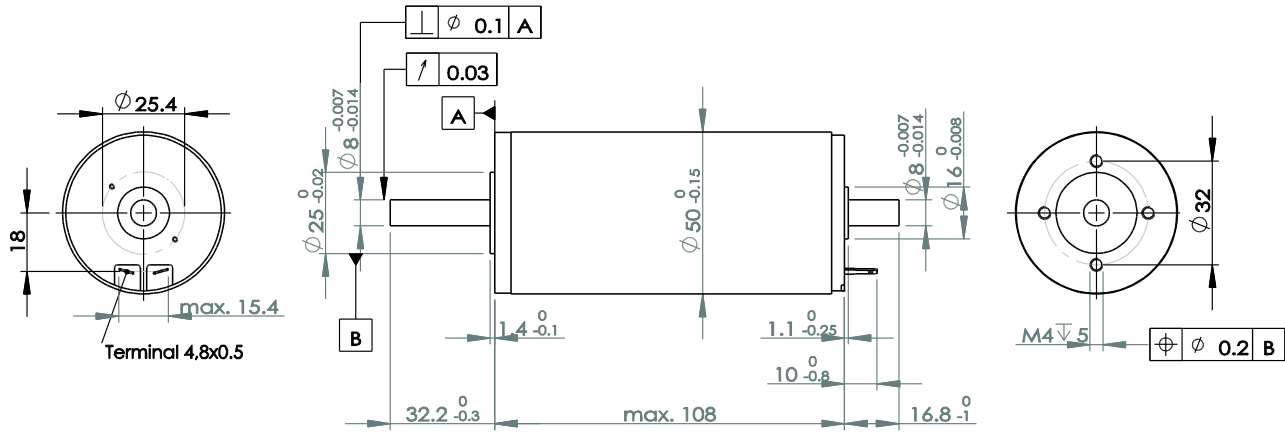
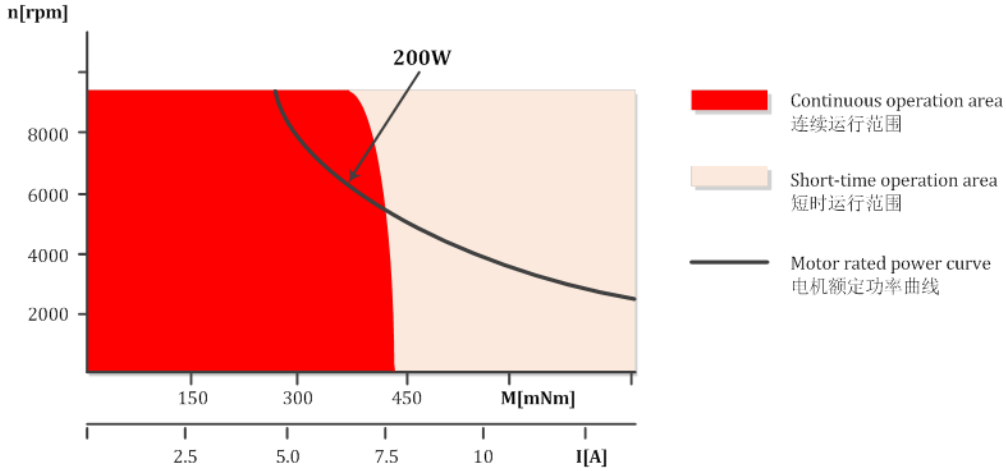

Dimension 尺寸图